

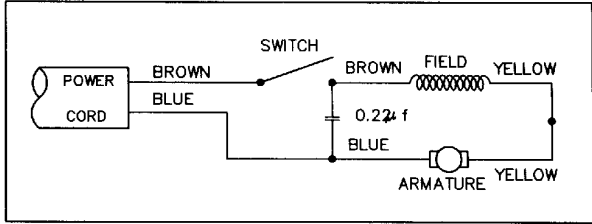

235mm Precision Power Saw SPARE PARTS LISTING

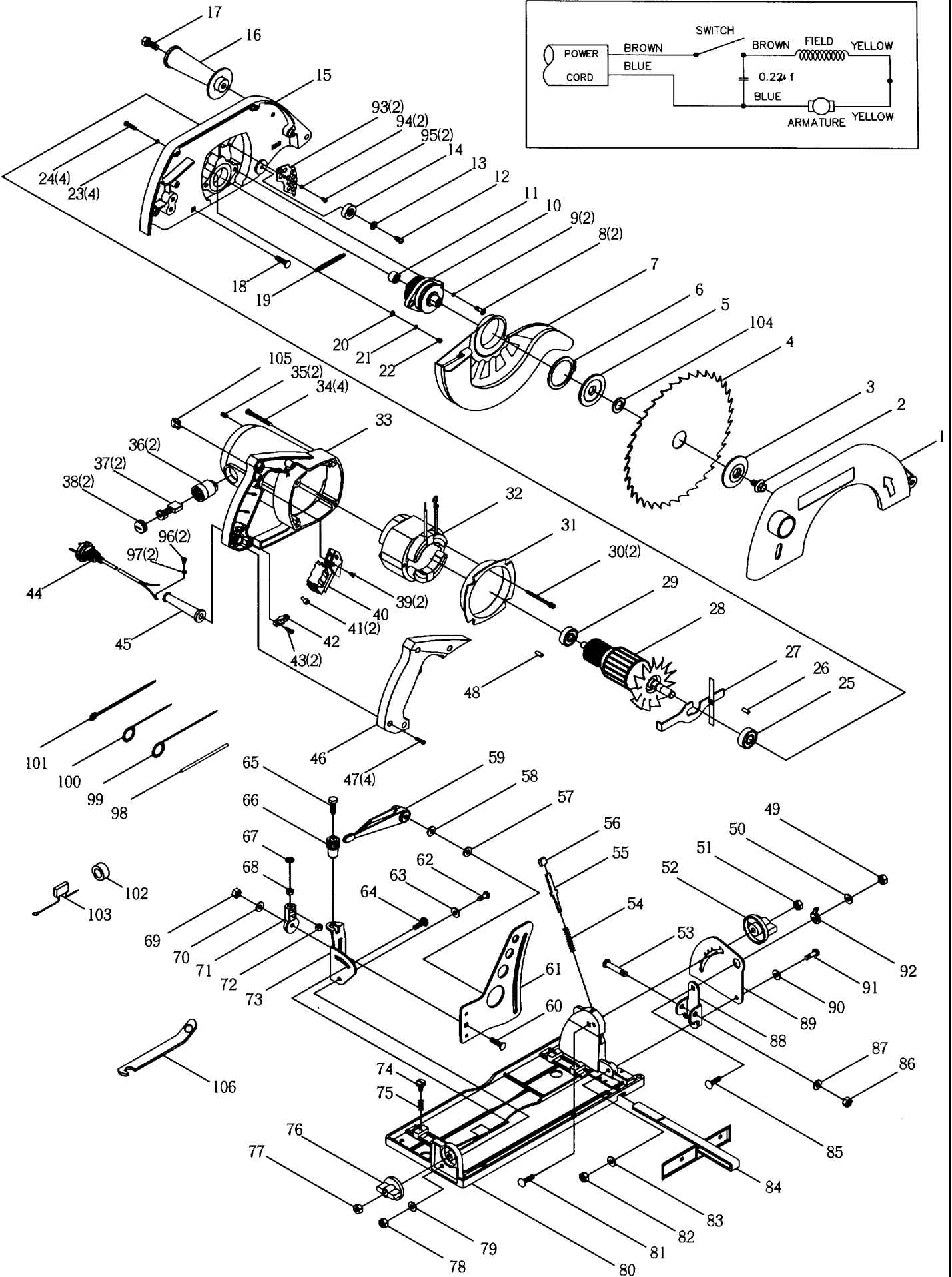

Item No.	Part No.	Description	Item No.	Part No.	Description
1	TSA019	Blade cover (labelled)	54	TSA027	Spring
1,15,23,24	TSA034	Blade housing, complete (labelled)	55	TSA007	Bevel detent latch
2	TSA044	Blade bolt	56	TSA014	Latch button
3	TSA045	Outer flange	57	TSA032	Fibre washer
4	TSA033	Blade, Triton 235mm 40 tooth	58	TSA039	Flat washer
5	TSA046	Inner flange	59	TSA013	Height lever
6	TSA049	External retaining ring	60	TSA028	Flat head coach bolt - M6
7	TSA018	Safety cover	61	TSA005	Height adjustment bracket
8	TSA050	Flat head screw M5x15	62	TSA029	Plain shank bolt - M6
9	TSA051	External tooth lock washer	63	CSA088	Washer - M6
10	TSA036	Jackshaft assembly	64	CSA171	Coach bolt - M6 x 30mm
11	TSA052	Needle bearing	65	CSA240	Hex head screw - M6 x 35mm
12	TSA053	Pan head screw M6x15	66	TSA010	Micro knob
13	TSA054	Flat washer	67	CSA088	Washer - M6
14	TSA055	Cushion	68	CSA090	Nyloc nut - M6
15	TSA020	Blade housing	69	CSA090	Nyloc nut - M6
16	TSA021	Side handle	70	CSA088	Washer - M6
17	TSA056	Hex head screw M8x20	71	TSA011	Micro slider
18	TSA030	Coach bolt (high tensile)	72	CSA173	Hex nut - M6
19	TSA057	Return spring	73	TSA006	Rear pivot bracket
20	TSA058	Flat washer	74	TSA024	Fence screw
21	TSA059	Spring lock washer	75	TSA027	Spring
22	TSA060	Pan head screw M4x10	76	CMA038	Round knob - M6 - small
23	TSA061	External tooth lock washer	77	CSA090	Nyloc nut - M6
24	TSA062	Pan head screw M5x20	78	CSA090	Nyloc nut - M6
25	TSA040	Ball bearing 6201	79	CSA088	Washer - M6
26	TSA063	Rubber pin	80	TSA002	Base plate
27	TSA064	Lock lever	81	CSA151	Coach bolt - M6 x 30mm
28	TSA037	Armature	82	CSA090	Nyloc nut - M6
29	TSA041	Ball bearing 6200	83	CSA088	Washer - M6
30	TSA065	Pan head tap screw D5x60	84	TSA017	Rip fence
31	TSA066	Fan guide	85	CSA241	Coach Bolt - M6 x 18mm
32	TSA042	Field assembly	86	CSA098	Nyloc nut - M8
33	TSA022	Motor housing (labelled)	87	CSA099	Washer - M8
34	TSA067	Pan head screw M5x55	88	TSA003	Front pivot
35	TSA068	Set screw M5x8	89	TSA004	Front quadrant
36	TSA069	Brush holder	90	CSA088	Washer - M6
37	TSA043	Brush	91	TSA031	Blade angle adjuster
38	TSA047	Brush cap	92	TSA015	Bolt - M6 - Plain shank
39	TSA070	Pan head tap screw D4x1082Sheath	93	TSA077	Cover (barrier)
40	TSA038	Switch	94		Spring lock washer
41		Wire nut	95		Pan head screw M4x10
42	TSA072	Cord clamp	96		Pan head screw #6x6.8mm
43	TSA073	Pan head tap screw D4x16	97		Tooth washer D3.5
44	TSA023	Cord & plug assy.	98		Cable sleeve
45	TSA074	Guard, cord	99	TSA078	Jumper wire
46	TSA035	Handle cover	100	TSA079	Jumper wire
47	TSA075	Pan head tap screw D4x20	101		Locking cable tie
48	TSA076	Rubber pin	102	TSA080	Coil
49	CSA090	Nyloc nut - M6	103	TSA081	Capacitor
50	TSA026	Washer - M6 - Small	104	TSA012	Blade bush - 25.0mm
51	CSA090	Nyloc nut - M6	105		Sheath
52	CMA047	Round knob - M6 - large	106	TSA009	Blade wrench
53	TSA025	Bolt - M8 - Plain shank special			